

**BOTTOM VIEW**

\* Applicable size of IC package : IC body size 7.0 x 7.0 mm  
IC outer size 9.0 x 9.0 mm

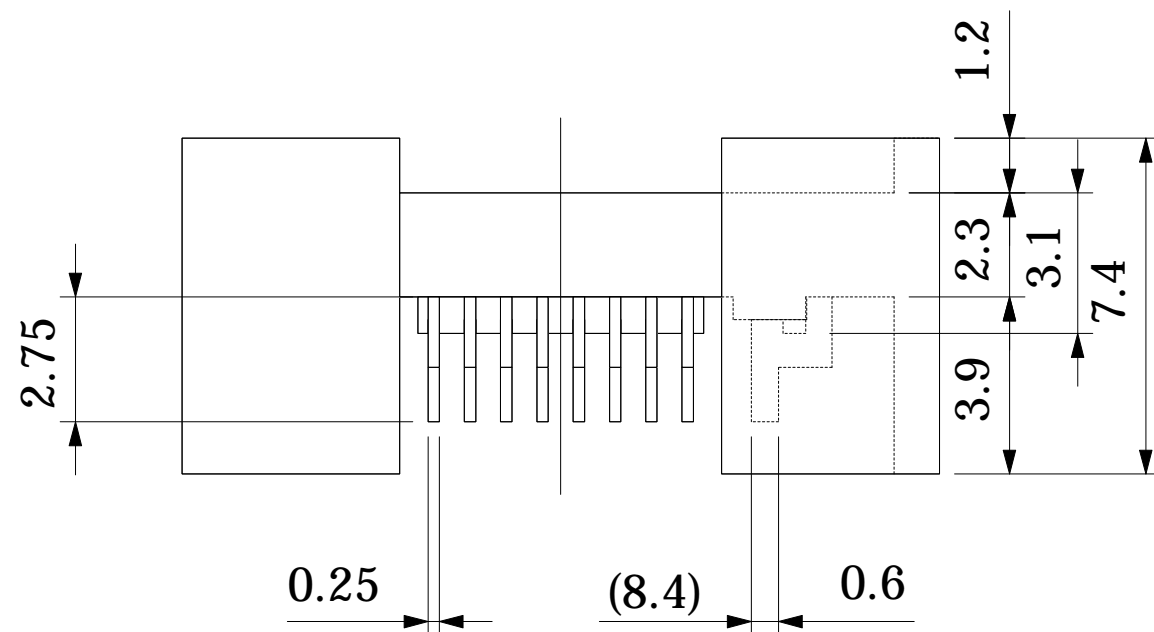

Part No.	<b>HQPACK032SA</b>
IC package	Square
Pin count	32Pin
Lead pitch	0.8mm
Unit : mm	Design : M.H
<b>TET</b> TOKYO ELETECH CORP.	