

4- A projection
height : 1.8mm

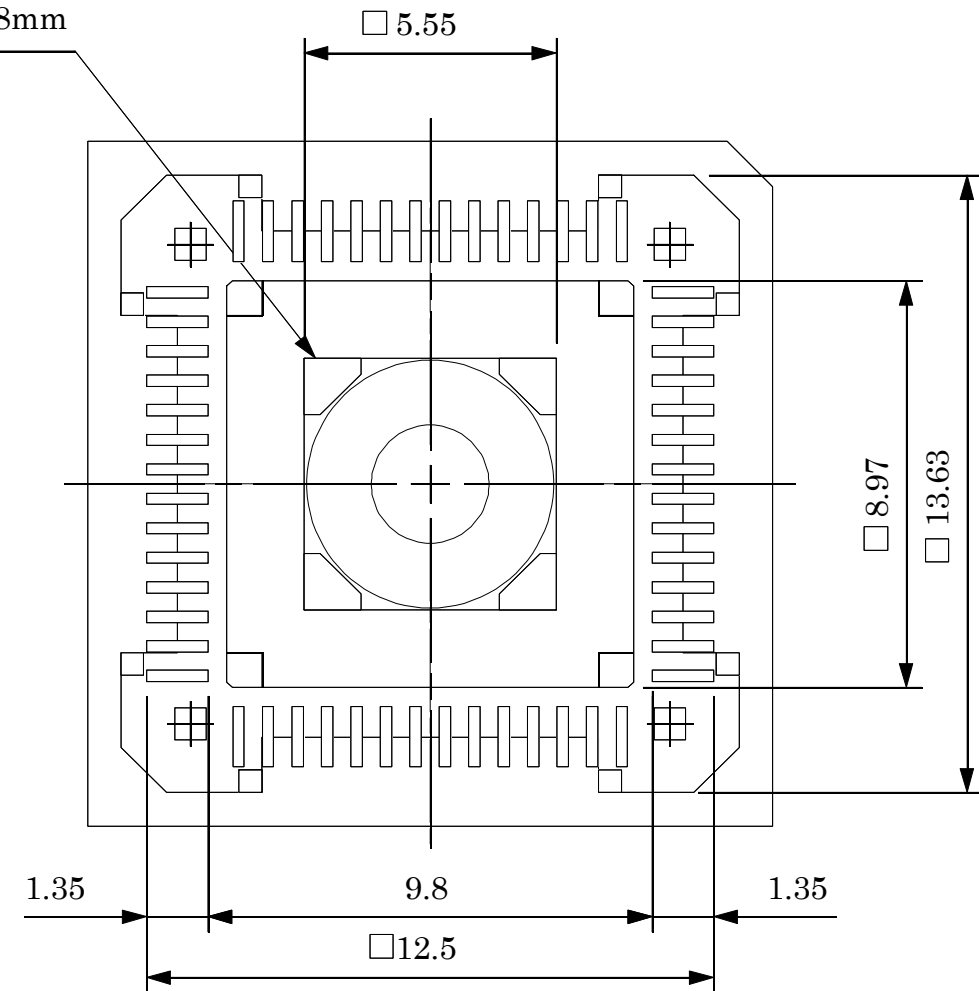

BOTTOM VIEW

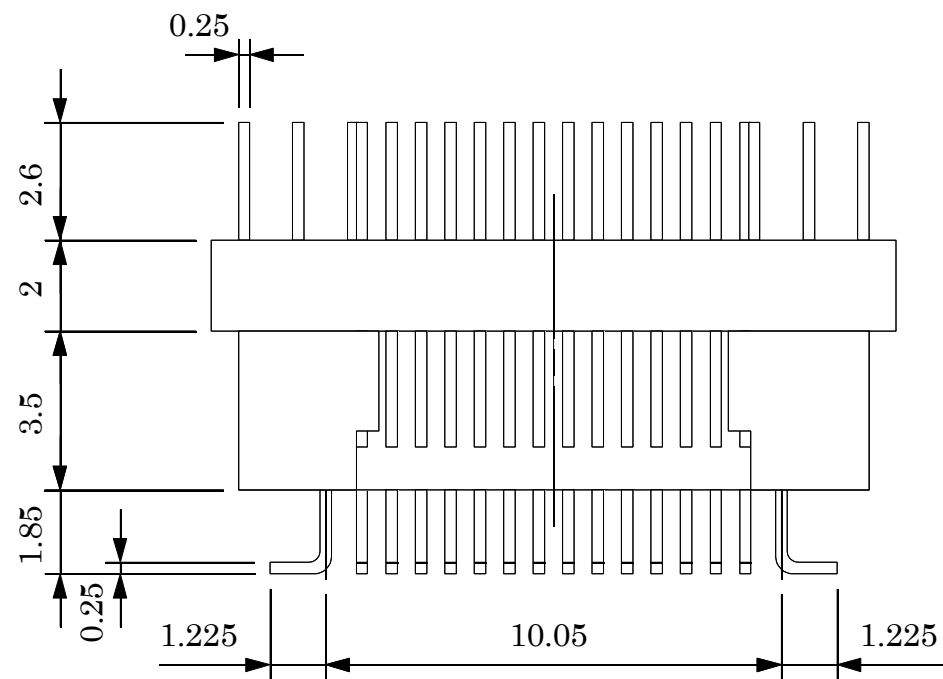

Part No.	TQPACK056SB
IC package	Square
Pin count	56Pin
Lead pitch	0.65mm
Unit : mm	Design : M.H
TET TOKYO ELETECH CORP.	

Recommended a PWB layout of TQSOCKET/YQSOCKET056SB Series

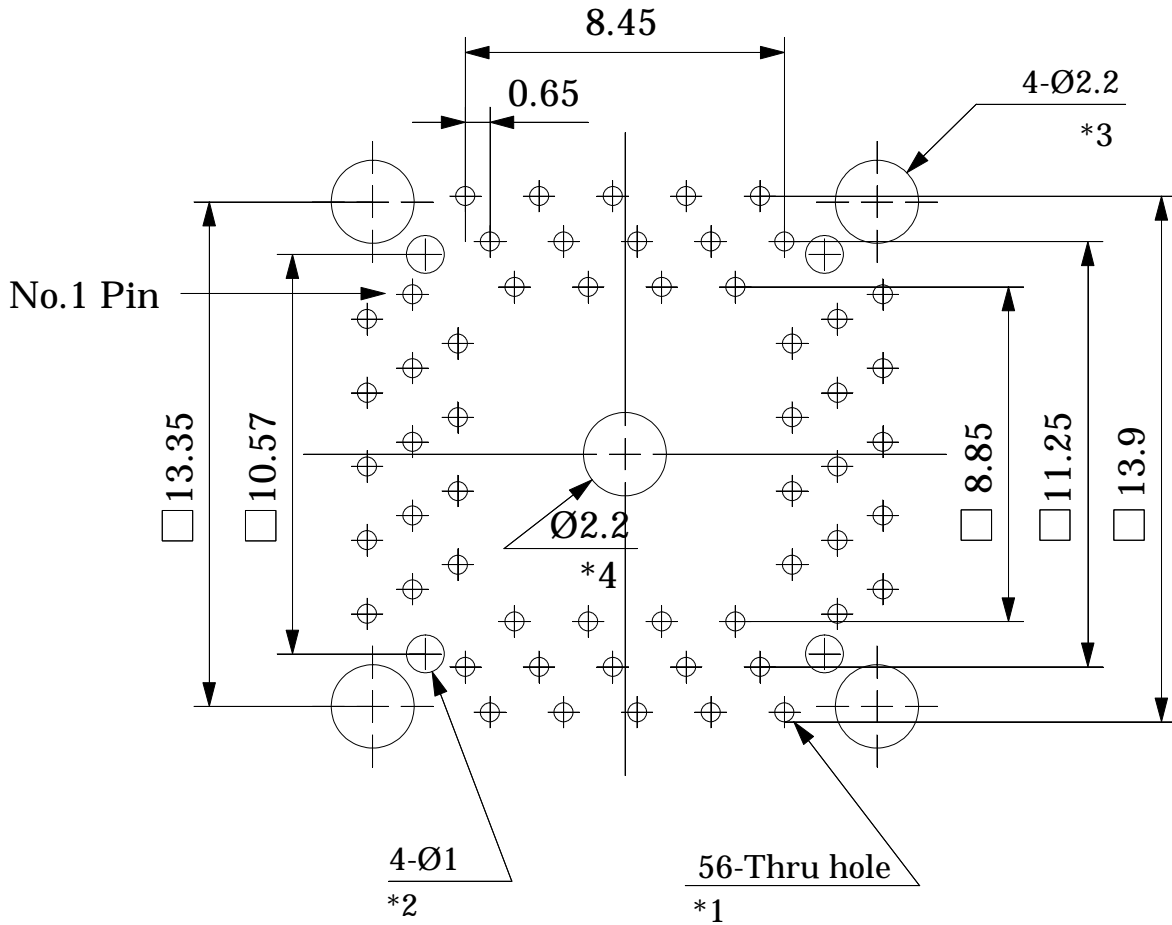

NOTES:

*1 \oplus mark is through hole.

The diameter is 0.5mm after plating copper on the hole.

*2 TQSOCKET guide pin hole and location.

*3 YQSOCKET guide pin hole and location.

*4 Screw hole and location for fastening TQSOCKET.

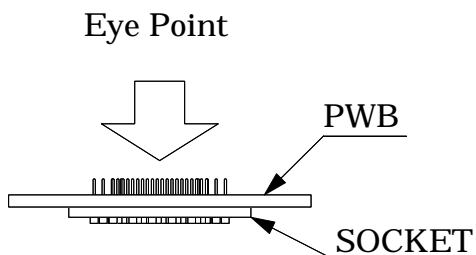

Part No.	TQ/YQ056SB	
IC package	Square	
Pin count	56Pin	
Lead pitch	0.65mm	
Unit : mm	Design : M.H	
TET TOKYO ELETECH CORP.		

Recommended a PWB layout of TQSOCKET/YQSOCKET056SB Series

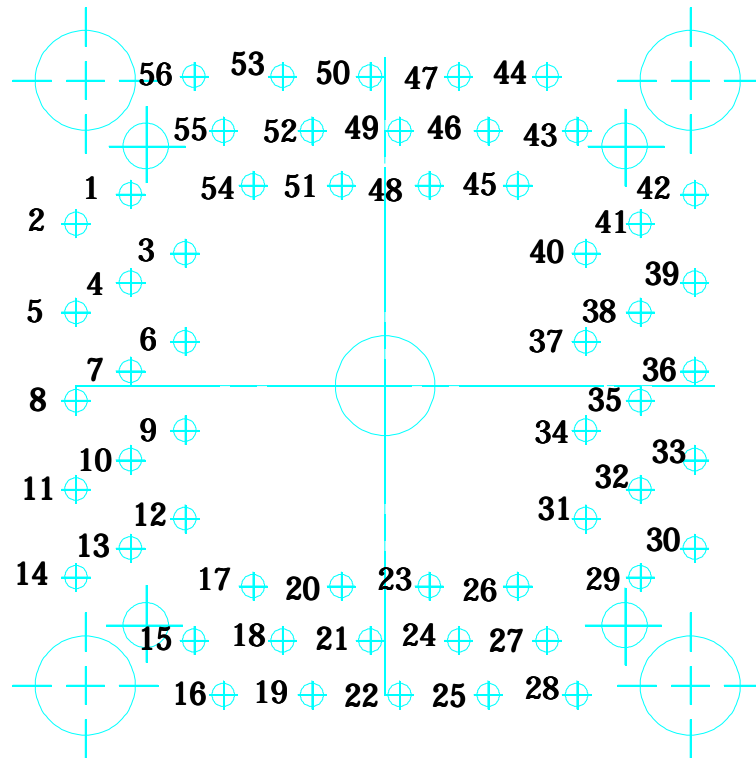

Eye Point

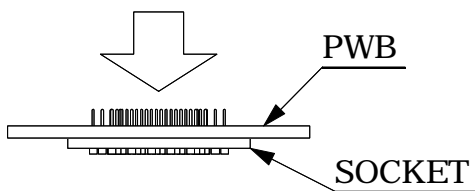

Part No.	TQ/YQSOCKET056SB	
IC package	Square	
Pin count	56	
Unit : mm	Design : M.H	
TET TOKYO ELETECH CORP.		

Recommended a Footprint pattern of TQPACK056SB

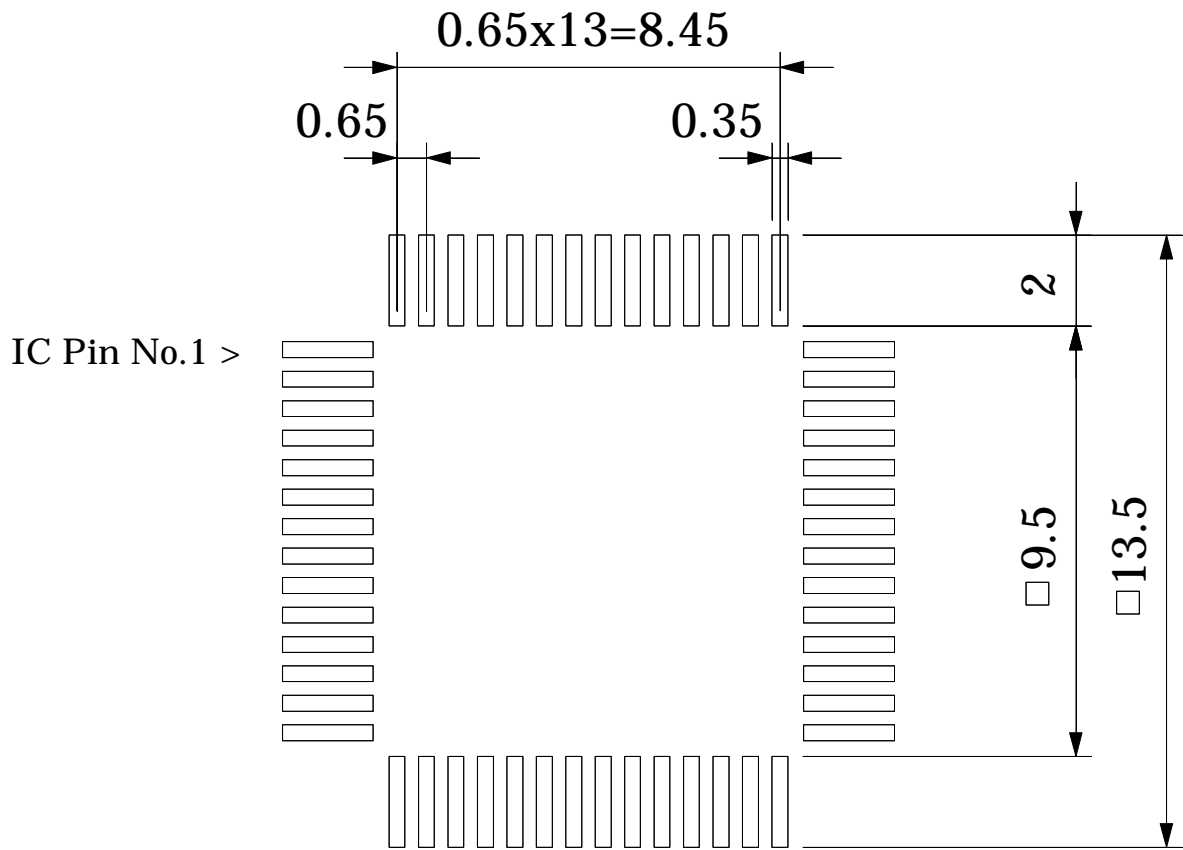

Part No.	TQPACK056SB	
IC package	Square	
Pin count	56Pin	
Lead pitch	0.65mm	
Unit : mm		Design : M.H
TET TOKYO ELETECH CORP.		